

Courtesy Of Anson Y Cheung Of 178 Real Estate Inc.

\$2,995 - 3801 103060 102 Street, Edmonton

MLS® #E4430817

\$2,995

2 Bedroom, 2.00 Bathroom, 813 sqft

Rental on 0.00 Acres

Downtown (Edmonton), Edmonton, AB

Experience luxury living with 24/7 concierge and security services, including convenient dry cleaning and delivery options. Enjoy a complimentary \$170/month Archetype Gym membership—a state-of-the-art wellness hub featuring steam rooms, yoga, spin, boxing, recovery equipment, Somadome meditation, towel service, hydration stations, Fit3D scans, postural analysis, and more. Indulge in building amenities like a swimming and whirlpool, billiards lounge, rooftop patio with optional Alchemy bar service, social spaces, and conference rooms. Interior boasts quartz counters, ceramic tile and engineered hardwood, stainless steel appliances, slow-close cabinets, spa-like bathroom, and premium finishings. Located in Edmonton's ICE District—connected to Rexall Place and steps from groceries, restaurants, cafés, LRT, Macewan, and the River Valley. Tenant expenses incld: insurance, power, internet/cable, and \$195/mo for heated underground parking. Pets negotiable—with rooftop dog run and nearby park!

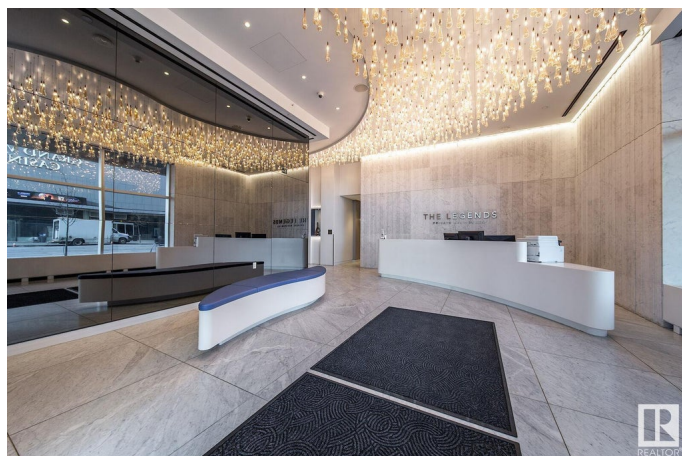
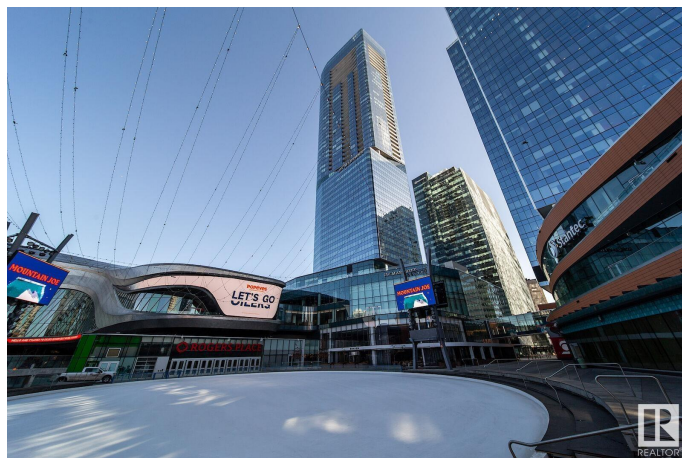

Built in 2019

Essential Information

MLS® # E4430817

Price \$2,995

Bedrooms	2
Bathrooms	2.00
Full Baths	2
Square Footage	813
Acres	0.00
Year Built	2019
Type	Rental
Style	Single Level Apartment
Status	Active

Community Information

Address	3801 103060 102 Street
Area	Edmonton
Subdivision	Downtown (Edmonton)
City	Edmonton
County	ALBERTA
Province	AB
Postal Code	T5J 4Y8

Amenities

Parking	Underground
---------	-------------

Interior

Appliances	Dishwasher-Built-In, Dryer, Hood Fan, Oven-Built-In, Refrigerator, Stove-Countertop Electric, Washer
------------	--

Additional Information

Date Listed	April 11th, 2025
Days on Market	17
Zoning	Zone 12

DATA IS DEEMED RELIABLE BUT IS NOT GUARANTEED ACCURATE BY THE REALTORS® ASSOCIATION OF EDMONTON. COPYRIGHT 2025 BY THE REALTORS® ASSOCIATION OF EDMONTON. ALL RIGHTS RESERVED. Trademarks are owned or controlled by the Canadian Real Estate Association (CREA) and identify real estate professionals who are members of CREA (REALTOR®, REALTORS®) and/or the quality of services they provide (MLS®, Multiple Listing Service®)

Listing information last updated on April 27th, 2025 at 9:31pm MDT